



PURSUIT PRF8530TA3

PURSUIT PRF8530TA3

Pursuit Series auto trailers are designed and built by Pace American, the nation's premier enclosed trailer company. Pursuit is designed for the racer or auto hauler looking for exceptional quality, value, and style. Standard features like automotive style weather-stripping, patented dust-proof sidewalls and treated no-rust fasteners show attention to even the smallest details.

A standard five-year limited warranty reflects our commitment to quality construction materials and manufacturing techniques refined by over 20 years of experience. Pace American is the recognized leader in automotive trailers with industry-leading customer service at our nationwide network of over 400 dealers.

Our on-site TrackSide Service program at select racing events is proof that with Pace, you're on the winning team.

STANDARD FEATURES

- 11 Standard Exterior Colors
- Patented Dust-Proof Sidewall Design for Strength and Cleanliness
- Truck Body Style Flat Top Roof Design
- Body Color Aluminum Wrapped Side Door and Rear Corner Posts
- Dexter Independent Torsion Suspension (ITS) Axles
- Non-Cracking TPO Front Cap
- Modular Style Steel Wheels with E-Coat Primer & Powdercoat Finish
- Frames are phosphate power washed and all exposed metal is painted with premium quality paint
- Chip Resistant Frame Undercoating
- Formed Steel Rear Header
- Zinc Plated Barlocks for Ramp Door
- Beavertail for Easy Loading
- SX Rear Ramp Door with Spring Assist and Flap
- Rust Resistant Galvaneal Sidedoor Stepwell
- Rust Resistant Galvaneal Rear Crossmember
- .030 Aluminum Exterior with 16" On-Center Wall Posts
- Automotive Quality Wiring Run Through Plastic Grommets in Trailer Frame
- 16" On-Center Frame Crossmembers
- 3/8" Plywood Interior Walls
- 3/4" Plywood Floor
- All Wheel Electric Brakes with 12v Breakaway Switch, Including Battery & Trickle Charger
- Mirror-Finished Stainless Steel Front Corner Wrap
- Chip Resistant Undercoating
- 6ft 9in Interior Height w/ 8in I-Beam
- (2)SX 12v Dome Lights w/Wall Switch (FW/GN Models)
- 5/3-Year Honest, Fast and Fair Limited Warranty
- 8" I-Beam Frame (GN/5th wheel)
- Dexter EZ Lube Hubs
- 48" Precision, Jig-Built, Solid Core Side Door w/Flushlock and Stainless Steel Piano Hinge
- 6" or 8" I-Beam Frame
- Safety Chains with Security Clasp Hooks

And More



Pace American trailers stand out from the crowd by offering better quality, design, and re-sale.



PURSUIT

PRF8530TA3

SPECIFICATIONS PRF8530TA3

| | |
|---|------------------------------|
| Overall Length | 30'6" |
| Interior Length | 30'0" |
| Box Width/OA Width | 8'4" / 8'6" |
| Box Height/OA Height | 8'3" |
| Interior Width | 8'0" / 6'9" |
| Interior Height (to center of roof bow) | 6'3" |
| Platform Height/Ball Height | 22" |
| Rear Doors | Ramp |
| Rear Door Width | 90" |
| Rear Door Height | 75" |
| Axles | 5000# Tandem |
| Brakes | Electric |
| Frame | 8" I-Beam |
| Tire Size | ST225 (75R15 LRD) |
| Hitch Ball Size | 2" Pin Box with Landing Gear |
| Curb Weight | 5788# |
| Hitch Weight | 1158# |
| Exterior | .030 Smooth |
| Floor | 3/4" Plywood |
| Sidewalls | 3/8" Plywood |
| Payload Capacity | 4212# |
| GVWR | 10,000# |
| Lower Deck Box Length | 21'8" |
| Sidewall Height | 6'0" |
| Riser Wall Height | 45" |
| Attic Interior Height | 30" |
| Loading Height | 17" |

NOTE: All standards, options, special packages, construction and specifications listed are subject to change. Photography may show optional items available at additional cost. Please consult your authorized dealer for the latest product information.

OPTIONAL EQUIPMENT

- Flooring Options
 - Side Door Upgrades
 - Access & Baggage Doors
 - Tie Downs
 - Wheel Upgrades
 - Finished Interior Packages Include- White Aluminum Walls, White Vinyl Ceiling, & Choice of Flooring w/ ATP on Ramp Door & Flap
 - Extra Height
 - Window Options
 - Finished Interiors
 - AC with or without Heatstrip
 - VHB by 3M Fastenerless Exterior
 - Electrical Packages (5 to choose from)
 - Spare Tire w/ Mount
 - Hydraulic Brakes
 - Air Line
 - D-Rings
 - E-Track: Floor or Wall
 - Air Compressor
 - Generator Prep Package
 - Carpeted Side Walls
 - Ladders- Interior or Exterior
 - Insulation- Wall or Ceiling • Escape Hatch
 - Aluminum Door Caddy
 - Aluminum Fuel Jug Holder
 - Tire Racks & Slick Hangers
 - 12v Winch
 - Power Roof Vent
 - Fluorescent Lights
 - 110v Wiring & Lighting
 - Dome Light (SX or LX)
 - Security Hasp for Side Door
 - ProStar Ramp System- Aluminum Extensions
 - Extra Wide Ramp Door (96" wide opening)
 - 12v Electric Tongue Jack
 - 36" Extended Ramp Flap
 - Roof Vents
 - Bogey Wheels
 - Ramp Over Wheel Wells • Aluminum Access Doors • Utility Doors
- And More

Auto hauling trailers are our specialty be it bumper-pull tag or gooseneck



Built for the long haul by offering better design, better quality, and better support after the sale



PACE TRAILERS ARE DESIGNED AND BUILT FROM THE GROUND UP BY PROFESSIONALS WHO ACTUALLY USE TRAILERS.

CUSTOMER SERVICE HOTLINE IS JUST ONE OF MANY WAYS PACE SUPPORTS YOU AFTER THE SALE. CALL US AT 800-247-5767 ANYTIME.

FRIENDLY DEALERS FROM COAST-TO-COAST MEANS YOU'LL NEVER BE STRANDED WHEN YOU CHOOSE PACE.



Your Closest Authorized Pace American Dealer:

Bestpricetrailers.com

FLOORPLAN PLAYGROUND

DATE: _____ TITLE: PLAN VIEW MODEL PRF 8530TA3 DWG NO: _____

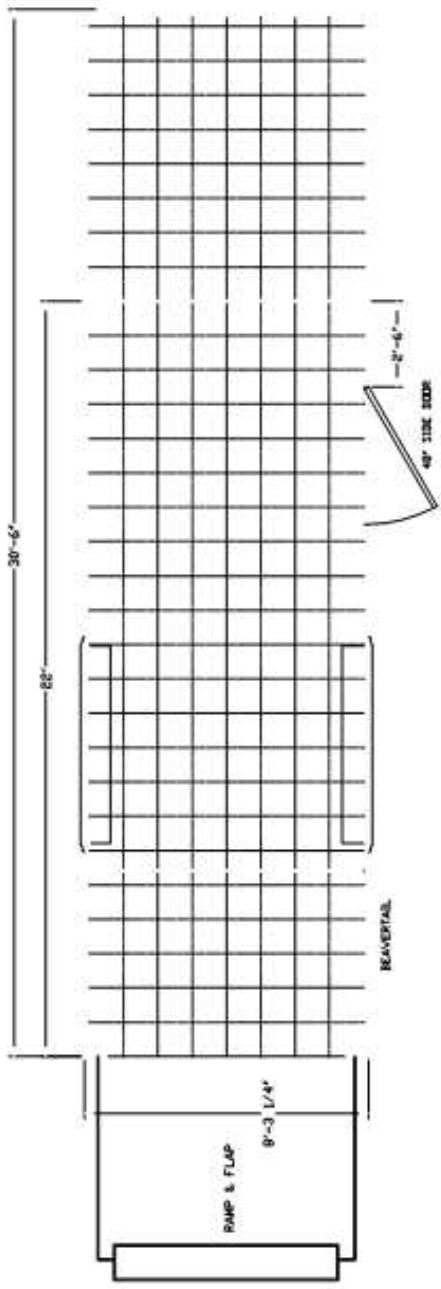

 11550 HARTER DRIVE
 MIDDLEBURY, IN. 46540
 APPROVED BY: _____
 SCALE: N.T.S. DWG. BY: RAM
 REVISED: _____

NOTES:
 GRID=12'x12' SQUARES

| REV. # | DATE | DESCRIPTION |
|--------|------|-------------|
| | | |
| | | |
| | | |
| | | |

PLEASE INQUIRE CLAIMS PROPRIETARY RIGHTS TO THE MATERIAL DISCLOSED HEREIN. NEITHER THIS DRAWING NOR ANY REPRODUCTION THEREOF MAY BE USED TO MANUFACTURE ANYTHING WITHOUT PERMISSION IN WRITING.